

Design Approach Sections



Section A
1:200



Section C
1:200

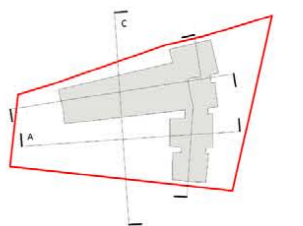

Design Approach Visualisations



View in the lower ground courtyard

Design Approach

Existing Elevations



Existing north elevation
1:200



Existing east elevation
1:200

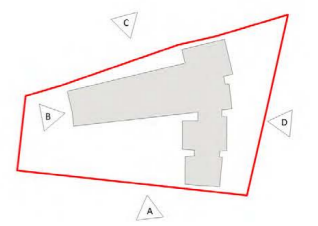

Design Approach Proposed Elevations



Site

Danson Park
Proposed north elevation
1:200



12 Danson Road

10 Danson Road

Site

Proposed east elevation
1:200

- | | | |
|---|--------------------------------------|---|
| 1. Metal frame for planted climbers | 5. Sun tunnel | 12. Masonry mullions |
| 2. Vertical standing seam red/brown VMZinc fascia system | 6. Red brick with light mortar | 13. Fixed window with integral inward opening section. Aluminium external facing in selected RAL colour tbc |
| 3. Vertical standing seam dark red/brown VMZinc fascia system | 7. Red/brown brick with dark mortar | 14. Full height glazing to enclose a winter garden |
| 4. Vertical standing seam grey VMZinc fascia system | 8. Red brick with dark mortar | |
| | 9. Red/brown brick with light mortar | |
| | 10. Fixed glazing | |
| | 11. Masonry window surround | |

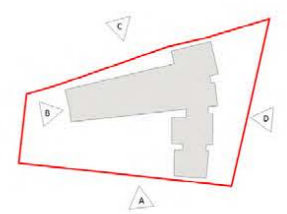

Design Approach

Existing Elevations



Existing south elevation
1:200



Existing west elevation
1:200

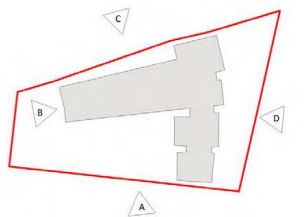

Design Approach Proposed Elevations



Proposed south elevation
1:200



Proposed west elevation
1:200

1. Metal Frame for planted climbers
2. Vertical standing seam red/brown VMZinc fascia system
3. Vertical standing seam dark red/brown VMZinc fascia system
4. Vertical standing seam grey VMZinc fascia system

5. Sun tunnel
6. Red brick with light mortar
7. Red/brown brick with dark mortar
8. Red brick with dark mortar
9. Red/brown brick with light mortar
10. Fixed glazing
11. Masonry window surround

12. Masonry mullions
13. Fixed window with integral inward opening section. Aluminium external facing in selected RAL colour tbc
14. Full height glazing to enclose a winter garden

